



## Shaldon Road

Edgware

£4,300 Per month

Davidson Frost-Wellings are pleased to present this spacious 5-bedroom end-of-terrace property conveniently located close to Queensbury Underground Station (Jubilee), Canons High, and Krishna Avanti schools.

This home has a double-storey side extension and comprises of a through lounge, kitchen, utility area, downstairs shower room, family bathroom, rear garden and ample parking.

Harrow council tax band D  
Available 25th April 2026  
Deposit of £4,961.53

### Viewing

Please contact our Davidson Frost-Wellings Office on 020 8954 8806 if you wish to arrange a viewing appointment for this property or require further information.

- Five bedrooms
- Three bathrooms
- Good condition
- Parking for three cars
- Available 25th April
- Private garden



# Floor Plan

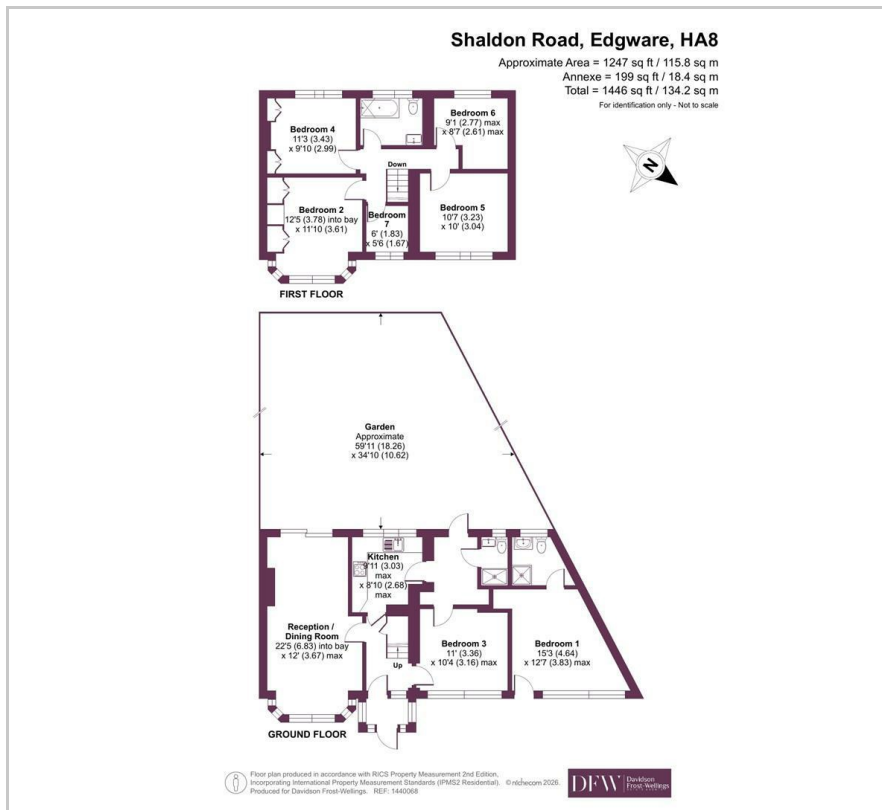

# Area Map

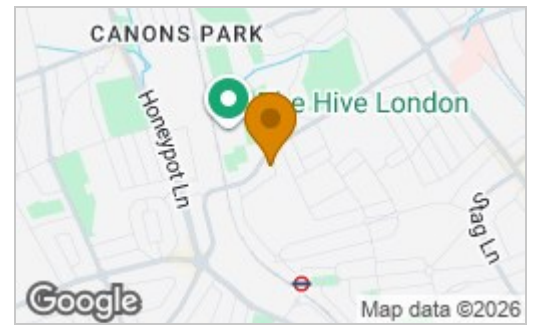

Energy Efficiency Rating		
	Current	Potential
<i>Very energy efficient - lower running costs</i>		
(92 plus) <b>A</b>		<b>86</b>
(81-91) <b>B</b>		
(69-80) <b>C</b>		
(55-68) <b>D</b>	<b>61</b>	
(39-54) <b>E</b>		
(21-38) <b>F</b>		
(1-20) <b>G</b>		
<i>Not energy efficient - higher running costs</i>		
<b>England &amp; Wales</b>		EU Directive 2002/91/EC



These particulars, whilst believed to be accurate are set out as a general outline only for guidance and do not constitute any part of an offer or contract. Intending purchasers should not rely on them as statements of representation of fact, but must satisfy themselves by inspection or otherwise as to their accuracy. No person in this firm's employment has the authority to make or give any representation or warranty in respect of the property.